

EXTERNAL DIMENSIONS

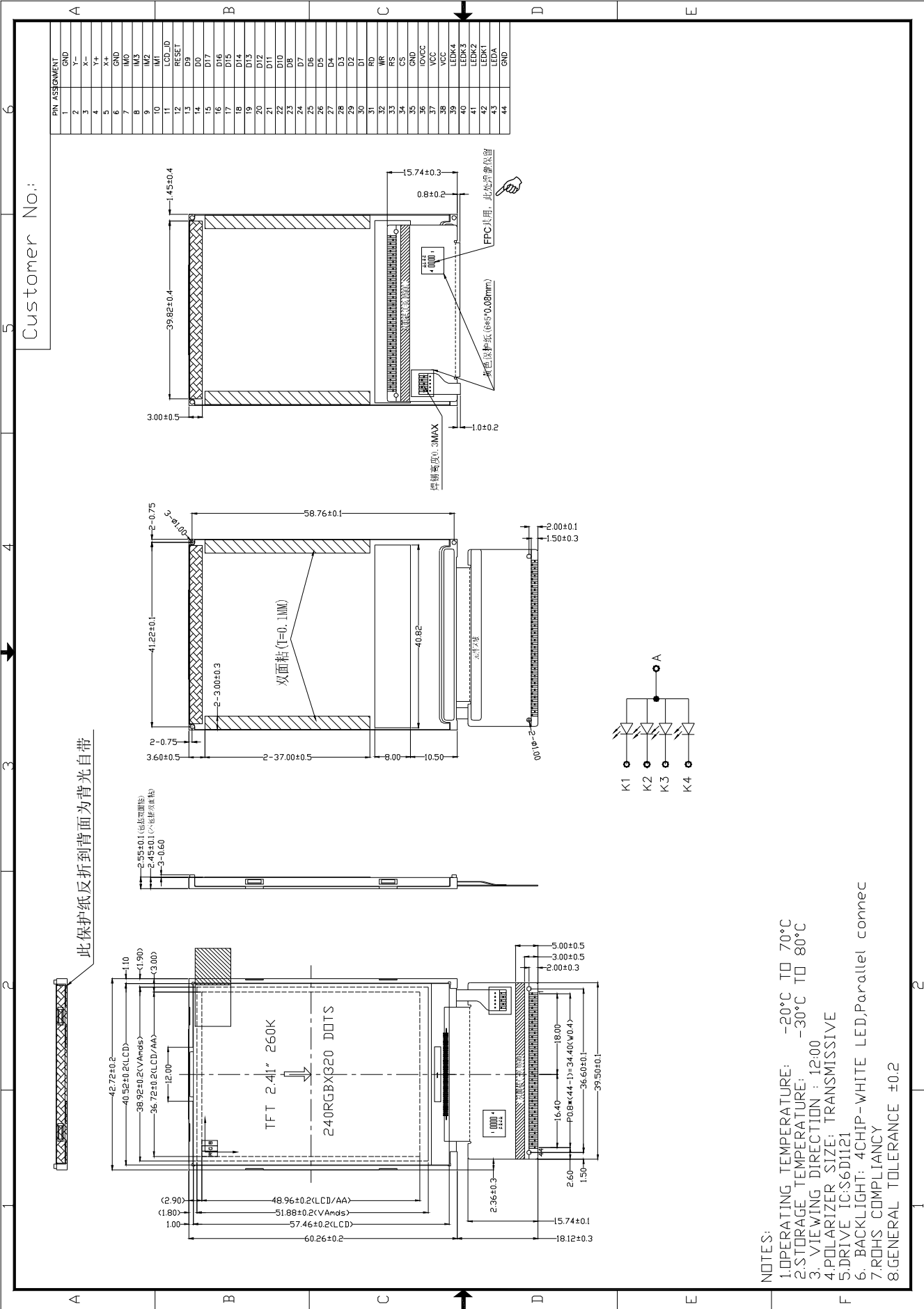

■ INTERFACE DESCRIPTION

| Pin No. | Symbol | Level | Description | | | | | |
|---------|--------|-------|------------------------|-----|-----|-----|-----------------------------|-----------------------|
| 1 | GND | 0V | Ground. | | | | | |
| 2 | Y- | - | No connection | | | | | |
| 3 | X- | - | No connection | | | | | |
| 4 | Y+ | - | No connection | | | | | |
| 5 | X+ | - | No connection | | | | | |
| 6 | GND | 0V | Ground. | | | | | |
| 7 | IM0 | H/L | IM0 | IM1 | IM2 | IM3 | Interface Mode | DB Pin |
| 8 | IM3 | | 0 | 1 | 0 | 0 | i80-system 16-bit interface | DB[10:17], DB[1:8] |
| 9 | IM2 | | 1 | 1 | 0 | 0 | i80-system 8-bit interface | DB[10:17] |
| | | | 0 | 1 | 0 | 1 | i80-system 18-bit interface | DB[0:17] |
| 10 | IM1 | | 1 | 1 | 0 | 1 | i80-system 9-bit interface | DB[9:17] |
| 11 | LCD_ID | - | Identify of LCD | | | | | |
| 12 | RESET | H/L | Reset signal pin | | | | | |
| 13 | D9 | H/L | Data bus | | | | | |
| 14 | D0 | H/L | Data bus | | | | | |
| 15 | D17 | H/L | Data bus | | | | | |
| 16 | D16 | H/L | Data bus | | | | | |
| 17 | D15 | H/L | Data bus | | | | | |
| 18 | D14 | H/L | Data bus | | | | | |
| 19 | D13 | H/L | Data bus | | | | | |
| 20 | D12 | H/L | Data bus | | | | | |
| 21 | D11 | H/L | Data bus | | | | | |
| 22 | D10 | H/L | Data bus | | | | | |
| 23 | D8 | H/L | Data bus | | | | | |
| 24 | D7 | H/L | Data bus | | | | | |
| 25 | D6 | H/L | Data bus | | | | | |
| 26 | D5 | H/L | Data bus | | | | | |
| 27 | D4 | H/L | Data bus | | | | | |
| 28 | D3 | H/L | Data bus | | | | | |
| 29 | D2 | H/L | Data bus | | | | | |
| 30 | D1 | H/L | Data bus | | | | | |
| 31 | RD | H/L | Read signal | | | | | |
| 32 | WR | H/L | Write signal | | | | | |
| 33 | RS | H/L | Register select signal | | | | | |
| 34 | CS | H/L | Chip select signal | | | | | |
| 35 | GND | 0V | Ground. | | | | | |
| 36 | IOVCC | 2.8V | I/O Power supply | | | | | |
| 37 | VCC | 2.8V | Power supply | | | | | |
| 38 | VCC | 2.8V | Power supply | | | | | |
| 39 | LEDK4 | - | LED light, cathode. | | | | | |
| 40 | LEDK3 | - | LED light, cathode. | | | | | |
| 41 | LEDK2 | - | LED light, cathode. | | | | | |
| 42 | LEDK1 | - | LED light, cathode. | | | | | |
| 43 | LEDA | - | LED light, anode. | | | | | |
| 44 | GND | 0V | Ground. | | | | | |